

Piston

Removal

4. Install the solenoid adjust springs on the modulator body.
5. Install the solenoid valves and set plate and secure with the hexagonal socket screws.
6. Install the solenoid cover and solenoid head.
7. Install the reservoir tank.
8. Install the tank filter.
9. Connect the low pressure hose.

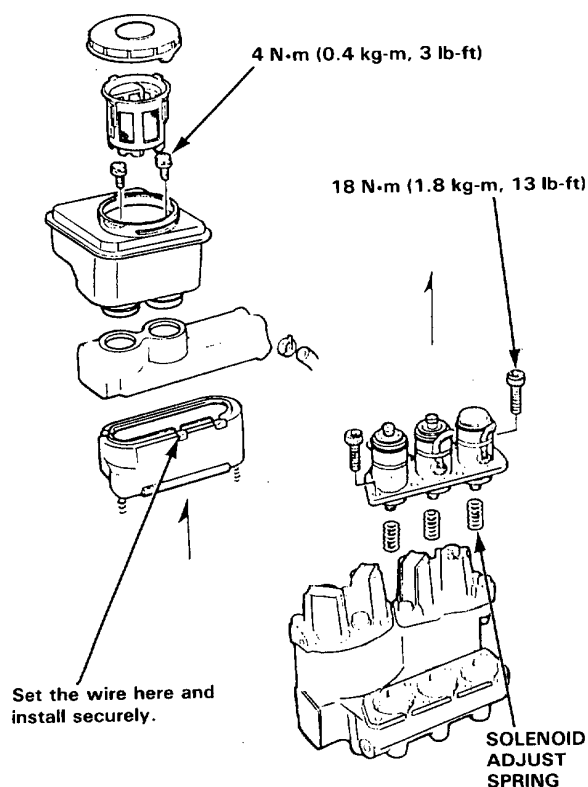

1. Remove the modulator heads.

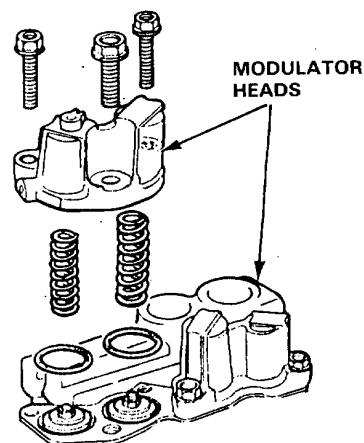

2. Insert the driver into the spring, pry off the piston assembly until it lifts up slightly and pull out the lock nut with a pair of pliers.

CAUTION:

- Set the washer between the driver and modulator body to prevent damage to the body.
- Be careful not to damage the piston sleeve.

